

# Perf-O Grip® Grating Load Tables

## Perf-O Grip — 2-Hole Plank — 5" Width

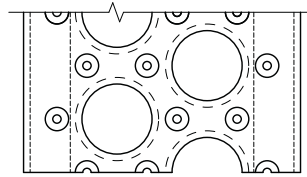

Perf-O-Grip

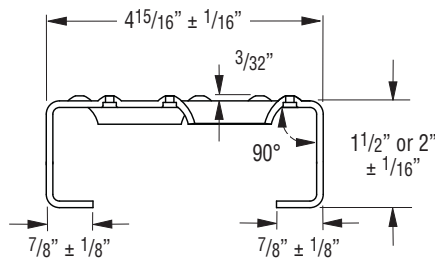
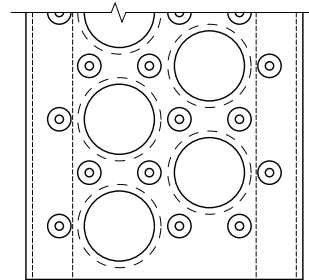

Perf-O-Grip 2

### Plank Selection/Design Tables

Allowable Loads and Deflections: U=Uniform Load (lb./ft.<sup>2</sup>) C= Concentrated Load (lb.) D=Deflection (in.)

Material Gauge	Channel Depth in. (mm)	Weight lb./lin. ft. (kg/m)	Catalog Number		Span																		
					2'-0"	2'-6"	3'-0"	3'-6"	4'-0"	4'-6"	5'-0"	5'-6"	6'-0"	6'-6"	7'-0"	7'-6"	8'-0"	9'-0"	10'-0"	11'-0"	12'-0"		
Steel 13 ga.	1 1/2" (38.1)	2.6 (3.8)	P21513*	U	2008	1287	895	659	505	400	325	269	227	194	168	146	130	103	85	70	60		
				D	.05	.08	.11	.15	.20	.25	.31	.38	.45	.53	.62	.71	.82	1.04	1.30	1.57	1.90		
	A21513	C	836	670	559	481	421	375	338	308	284	263	244	229	216	194	176	162	150				
		D	.04	.06	.09	.12	.16	.20	.25	.30	.35	.43	.49	.57	.65	.83	1.04	1.27	1.52				
	2" (50.8)	2.8 (4.1)	P22013*	U	3035	1944	1352	994	762	603	490	405	341	292	253	221	194	155	126	105	89		
				D	.04	.06	.09	.12	.15	.19	.24	.29	.34	.41	.47	.54	.62	.79	.98	1.20	1.43		
A22013	C	1228	1003	845	725	635	566	510	465	427	395	368	344	324	290	263	240	223					
	D	.03	.05	.07	.09	.12	.15	.19	.23	.28	.32	.38	.43	.50	.63	.79	.96	1.15					
Alum. 0.125"	2" (50.8)	1.3 (1.9)	P220125*	U	2910	1863	1294	950	728	575	466	385	323	276	237	207	182	143	116	96	81		
				D	.08	.12	.18	.24	.32	.40	.50	.60	.72	.84	.98	1.12	1.27	1.61	1.99	2.41	2.87		
			A220125	C	1213	970	809	693	606	539	485	441	404	373	346	323	303	270	243	221	202		
				D	.06	.10	.14	.20	.25	.32	.40	.48	.57	.67	.78	.90	1.02	1.29	1.60	1.93	2.29		
Stainless Steel 16 ga.	2" (50.8)	2.1 (3.1)	P22016S*	U	2781	2049	1422	1046	800	632	512	424	355	303	262	227	200	159	128	106	89		
				D	.05	.08	.12	.16	.21	.26	.32	.39	.46	.54	.63	.72	.82	1.04	1.28	1.56	1.85		
			A22016S	C	1334	1066	889	761	666	593	534	485	445	410	381	355	334	296	267	243	223		
				D	.04	.06	.09	.13	.16	.21	.26	.31	.37	.43	.50	.58	.66	.83	1.03	1.25	1.48		
Stainless Steel 14 ga.	2" (50.8)	2.1 (3.1)	P22014S*	U	3684	2410	1673	1230	942	744	602	498	418	357	307	267	235	186	151	125	105		
				D	.06	.08	.13	.17	.22	.27	.34	.41	.49	.57	.66	.77	.87	1.10	1.36	1.65	1.95		
			A22014S	C	1569	1255	1046	896	784	697	627	570	523	482	448	418	392	349	314	286	262		
				D	.05	.07	.10	.14	.17	.22	.27	.33	.39	.46	.54	.61	.70	.88	1.09	1.31	1.57		

\* Perf-O Grip: To order standard Perf-O Grip Grating use part number "Pxxxxx".

Perf-O Grip 2: To order New Perf-O Grip 2™ Grating use part number "Axxxxx". End margins are standard on new Perf-O Grip 2™ Grating 2-Hole through 6-Hole Plank only (5" through 12" widths). Standard lengths are 10'-0" and 12'-0". Longer lengths of 20'-0" and 24'-0" are available on both Perf-O Grip and Perf-O Grip 2™. Consult factory.