

Beams

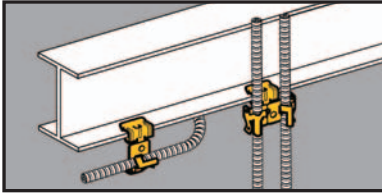

- Attaches MC, AC, sizes 14/2 through 10/3 or 3/8" FMC to beam flanges 1/8" to 3/4" thick.
- Fasteners will rotate 360°.
- Simply installed with a hammer.

Cable To Beam Fasteners



UPC/Part Number	Catalog Number	Type of Runs	Flange Thickness	Box Qty.
781011 01192	BX4-E-2-4	Single	1/8" - 1/4"	100
781011 01193	BX4-E-5-8	Single	5/16" - 1/2"	100
781011 01194	BX4-E-9-12	Single	9/16" - 3/4"	100

Beams



UPC/Part Number	Catalog Number	Type of Runs	Flange Thickness	Box Qty.
781011 01213	BX4M-E-2-4	Double	1/8" - 1/4"	100
781011 01214	BX4M-E-5-8	Double	5/16" - 1/2"	100
781011 01215	BX4M-E-9-12	Double	9/16" - 3/4"	100

Read safety/installation instruction sheets in packages before use. These products are designed for positioning only. No load rating.

